

Concealed Head

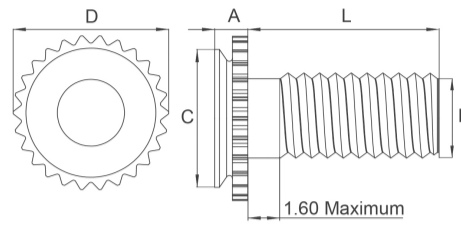
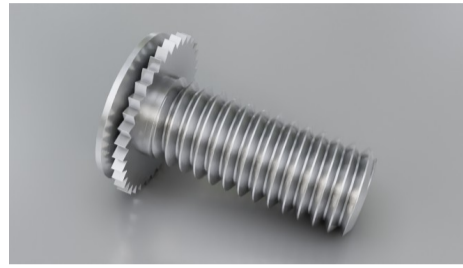
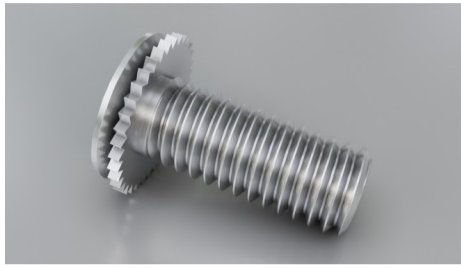

Type: SF-CHC or SF-CHA (1.6mm Sheet)

Type: SF-CFHC or SF-CFHA (2.4mm Sheet)

SF-CHC/SF-CHA

Lengths

6/8/10/12/20

Material Code

Stainless steel = SF-CHC or SF-CFHC

Aluminium = SF-CHA or SF-CFHA

How to order

Type + Thread + Length

Example: SF-CHC-M3-10 or SF-CFHC-M5-16

Thread	A 1.6mm Sheet max. mm	A 2.4mm Sheet max. mm	C max. mm	D ± 0.4 mm	L ±0.4 mm	Blind Mounting Hole ± 0.08 mm	Hole Depth 1.6mm Sheet mm	Hole Depth 2.4mm Sheet mm	Distance Centre Hole to Sheet Edge min. mm	Please note!
M3	1.04	1.83	4.35	5.21	6-20	4.37	1.10	1.91	4.0	
M4	1.04	1.83	7.35	8.33	6-20	7.37	1.10	1.91	5.6	
M5	1.04	1.83	7.90	8.89	10-20	7.93	1.10	1.91	6.4	

